

# JS140 02



WH : White

COLOR VARIATION :



SHARE :  

ARTIST DETAIL >

## SPEC

### SPEC

neck type	JS / Maple neck
top/back/body	Basswood body
fretboard	Jatoba / White dot inlay
fret	Medium frets
bridge	Edge-Zero II tremolo bridge
string space	10.8mm
neck pickup	Infinity RD (H) neck pickup (Passive/Ceramic)
bridge pickup	Quantum (H) bridge pickup (Passive/Ceramic)
hardware color	Chrome

### NECK DIMENSIONS

Scale :	648mm/25.5"
a : Width	42mm at NUT
b : Width	56mm at 21F
c : Thickness	20mm at 1F
d : Thickness	22.3mm at 12F
Radius :	240mmR

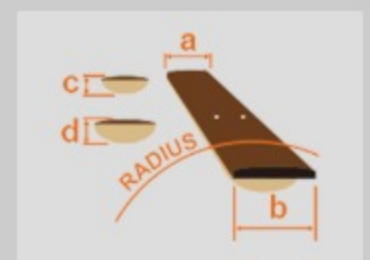

### SWITCHING SYSTEM

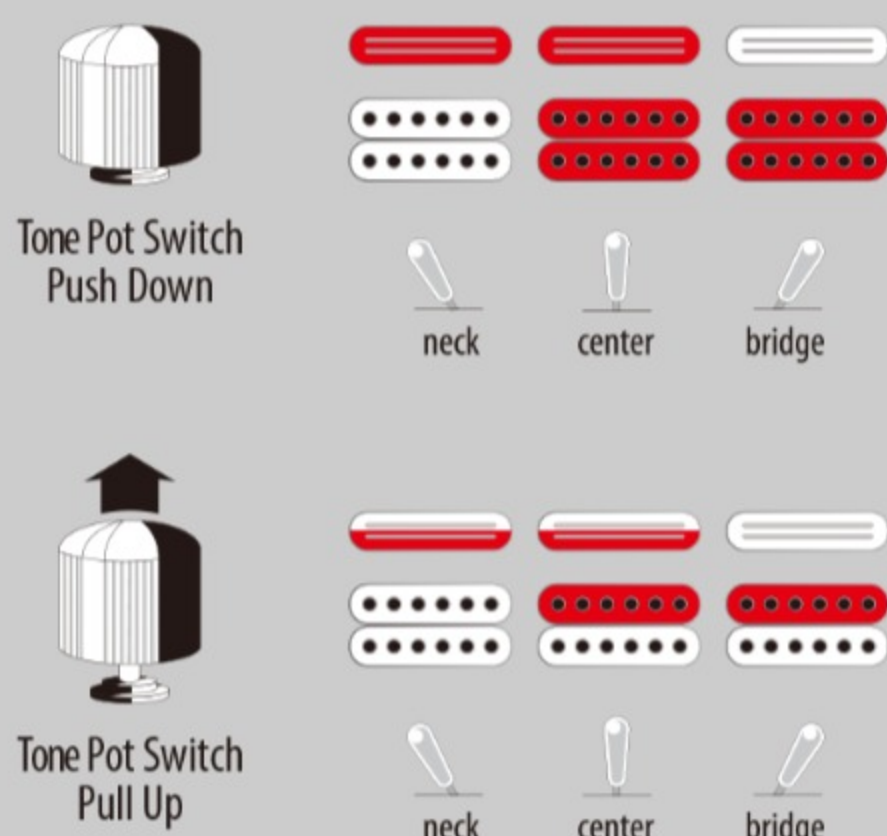

### CONTROLS

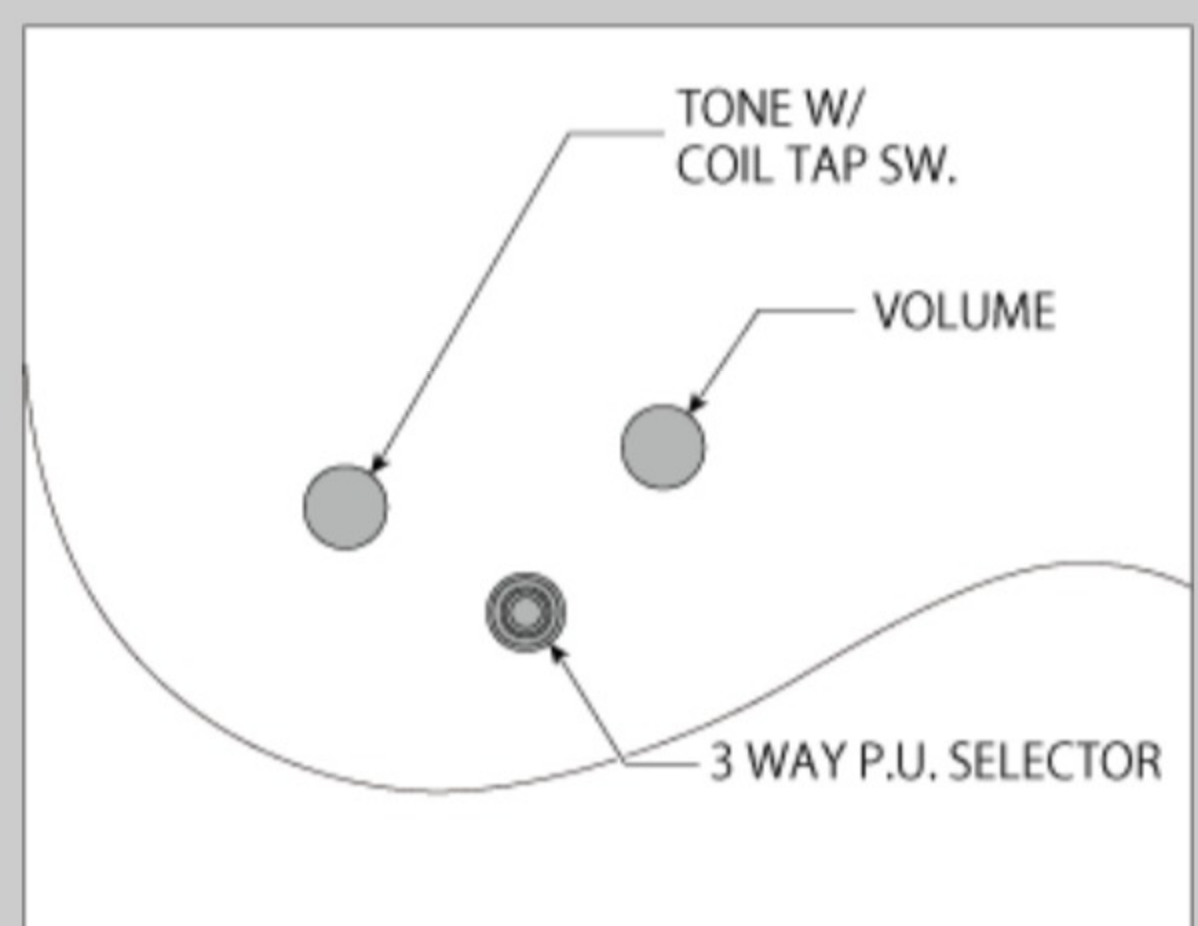

### OTHERS

Recommended M300C

Case

Coil-tap switch on tone control (push/pull)