

# TAMA Guitar Stand (839)

## Instruction Manual

Thank you for purchasing the TAMA Guitar Stand. To ensure safe and efficient use, please read this entire manual before using this product.

Please store this manual in convenient place for future reference.

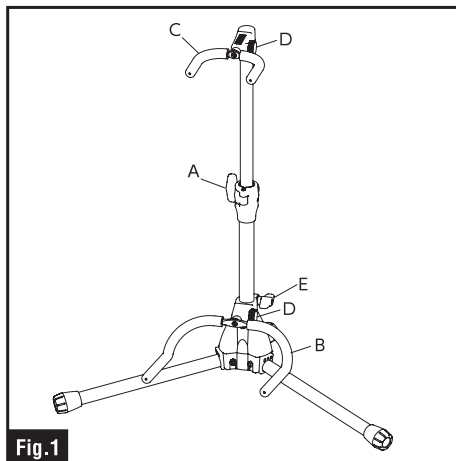

### Parts Overview (Fig.1)

- A: Neck Holder Height Adjustment T-Nut
- B: Body Holder
- C: Neck Holder
- D: Holder Locking Knob
- E: Body Holder Height Adjustment T-Nut

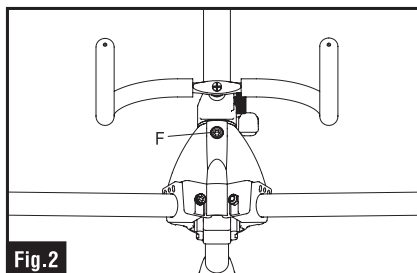

 **Note**

- The hex screw (F) in Fig.2 is used to secure the base to the lower tube and is pre-assembled and glued. There is no need to loosen this screw during assembly or folding.
- When placing a lacquered guitar on the stand, there is risk of changes or discoloration to the finish over time. If using a lacquered guitar, cover the rubber holder with a cloth to prevent direct contact with the guitar.

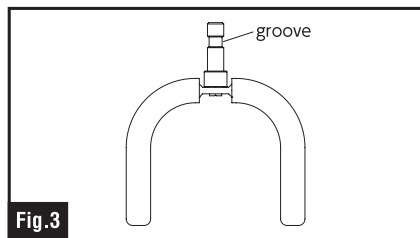

### How to Use

- Open the tripod base and place the stand on the floor.
- Loosen T-Nut (A) and extend the upper tube to the appropriate height. Then, tighten (A) to secure it firmly in place.
- Insert the Body Holder (B) and Neck Holder (C) into the corresponding brackets. The shaft of Body & Neck Holders features retention grooves as shown in Fig.3. Attach the holder to each bracket and tighten the lock knobs (D), but do not overtighten. The holder will naturally rotate to match the shape of the guitar's body.
- Loosen T-Nut (A) and adjust the height of the neck holder to accommodate your instrument, then tighten (A) to secure it firmly in place.
- Loosening T-Nut (E) allows the height of the Body Holder bracket (G) to be adjusted for accommodating various body shapes (Fig.4).

